

Appendix C - Backdale Quarry – Layout of Proposed Employment Development

Indicative Site Plan

Backdale Quarry

The 9th to 10th
15-12 High Street
E & W. 10th Street, 2nd
S21 4DN

+44 (0)1284 423410
M&A Group Ltd
www.m-a.co.uk

| Rev | Description | Date | By |
|-----|--|----------|----|
| A | Design file changes | 15/02/16 | AP |
| B | Planning Parking layout | 15/02/16 | AP |
| C | Access & quarry entrance revised as per client request | 08/03/16 | AP |
| D | Open quarry for being covered as per client request | 12/03/16 | AP |
| E | Proposed building footprint as per client request | 15/03/16 | AP |

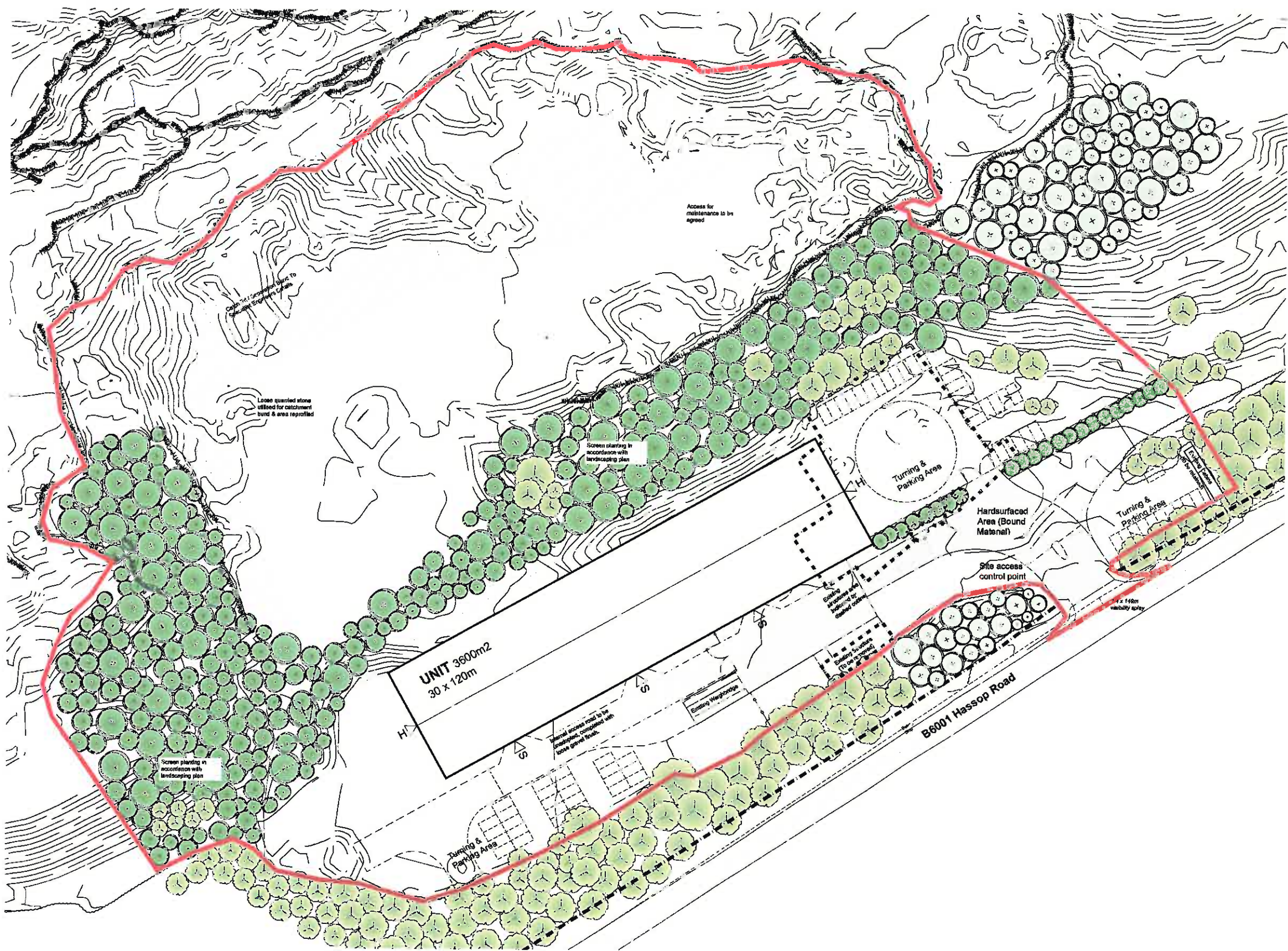

Key

- H ▷ HOV Capable unit entrance / egress
- S ▷ Service Vehicle entrance / egress
- ⊗ Indicative existing trees
- ⊙ New Screen Planting (See Landscaping Management Proposal)
- 0.00FFL Indicative finished floor levels
- ▭ Proposed Building
- ▭ Existing Structure
- ▭ Paved surfacing
- ▭ Unbound surfacing
- ⋯⋯⋯ Indicative Footpath route

Schedules

| Application | Area | Size (Ha) | Size (Acres) |
|------------------------------------|------|-----------|--------------|
| Red Edge | | 4.63 | 16.02 |
| Proposed Development Area (Shaded) | | 1.31 | 3.24 |
| Existing Structure (Removed) | | 0.18 | 0.75 |

| Room/Module | Area |
|-----------------|-----------------------------------|
| Employment Unit | 3000m ² (68,750 sq ft) |
| | 3600m ² (68,750 sq ft) |

| Room Type | Total |
|-----------------------------------|-------|
| Car Spaces (Internally Indicated) | 65 |

Site Plan (Scale 1:500)

Please refer to Indicators. The scale on drawings is for reference only.



Client: Bleeklow Industries Limited Date: Feb 2016
Project: Backdale Quarry Drawn: AP, FD